



! IMPORTANT.

Read this notice before connecting your helmet!

WIRED-WIRELESS (WW) TECHNOLOGY ALLOWS YOU TO SWITCH SEAMLESSLY FROM ONE COMMUNICATION MODE TO THE OTHER. CONNECT THE HELMET VIA NEXUS FOR WIRED MODE AND DISCONNECT IT TO GO WIRELESS WITH NO COMMUNICATION INTERRUPTION. COMMUNICATE IN ANY CONDITION THANKS TO WW TECHNOLOGY.

WW SIDE COVER CONTENTS:

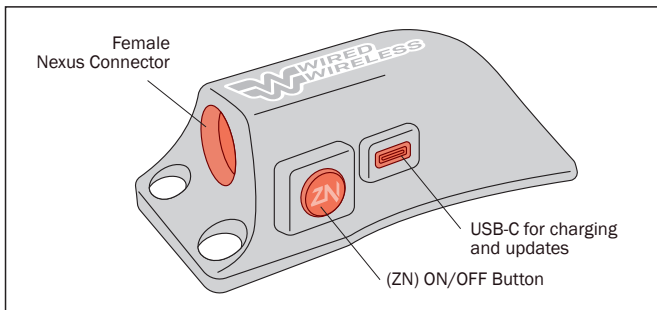

POWER ON AND PAIRING:

1. To turn on the WW Bell helmet, press the ZN button at the bottom of the side cover, the light will turn on.
2. To reset the helmet and be sure it is unpaired from any WW intercom, quickly press the ZN button 3 times. Three fast flashes signal a successful reset. The light will keep blinking until a connection is established.
3. Long press the (black) helmet icon on the WW intercom display to start pairing procedure. The light on the helmet will stop flashing when the helmet is paired and connected to the intercom. The helmet icon on the intercom will turn red and then blue.
4. A green light on the ZN button indicates a battery level above 20%; the light will become red when battery level is below 20%. Red light also signals when the Bell helmet is charging.
5. To turn off the Bell helmet, press and hold the ZN button at the bottom of the side cover until the light turns off.

WW FEARLESS AMPLIFIER CONNECTION ICONS:



BLACK: No helmet has been paired, you can pair a new helmet.

RED: A helmet has been paired, but it is currently not connected. Turn ON the helmet to connect it to the intercom.

BLUE: The helmet is paired and connected to the intercom. The battery state of charge is constantly updated. Four full bars indicates a battery level above 80%, four empty bars mean battery level below 20%.

! NOTE

It is necessary to recharge the battery at least once every six months. This guarantees the full functionality of the Wired-Wireless Technology.

! NOTE CUSTOM PAINTING

Paint curing must be carried out at room temperature. Electronics must not be exposed to more than 45 celsius degrees. The power button as well as the USB port must be properly masked not to let any chemicals leaking inside and damage the electronics.